

Side View - Wheelchair Accessible

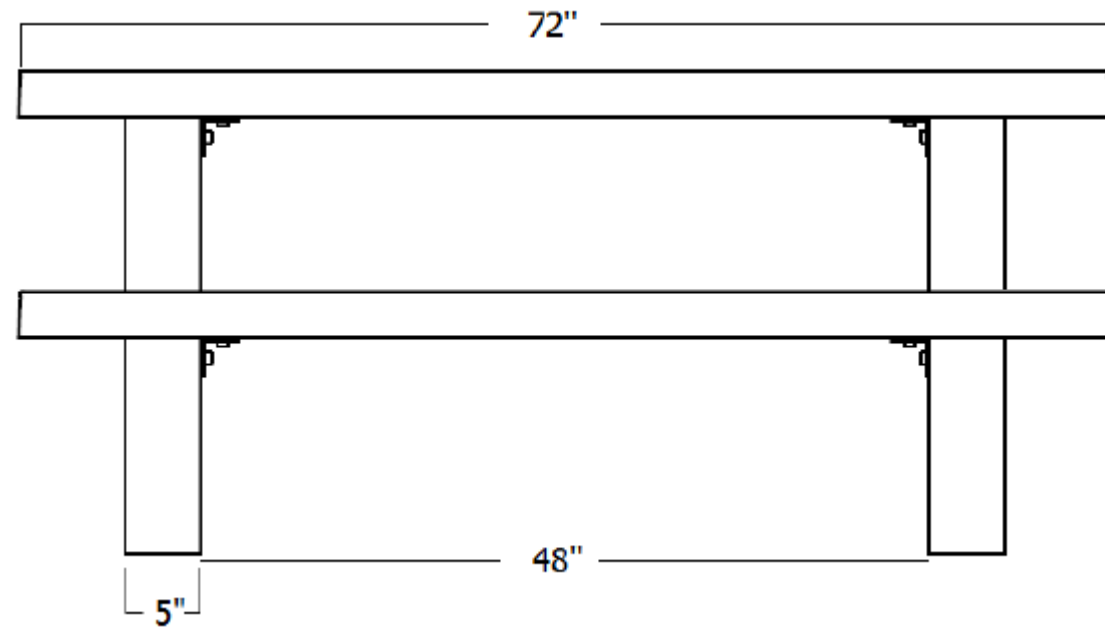

Side View - Regular Table

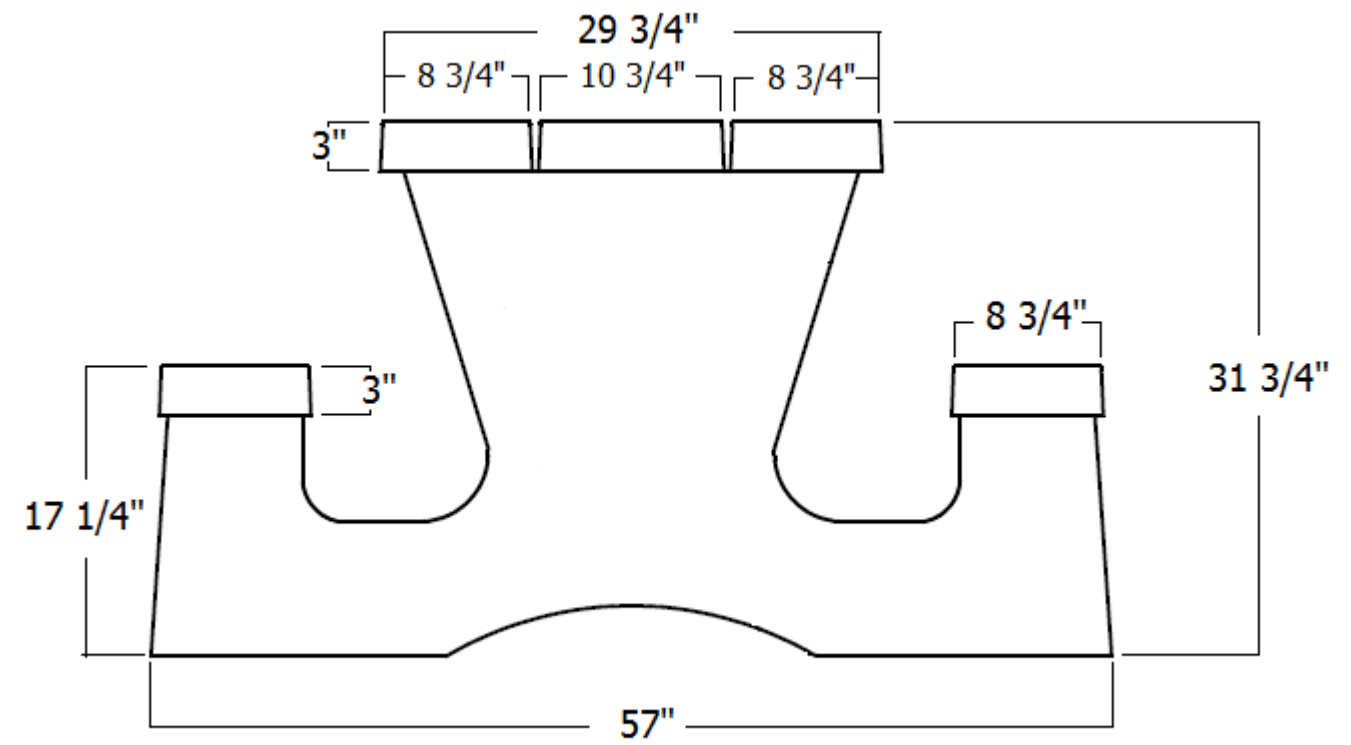

End View

*Not to scale

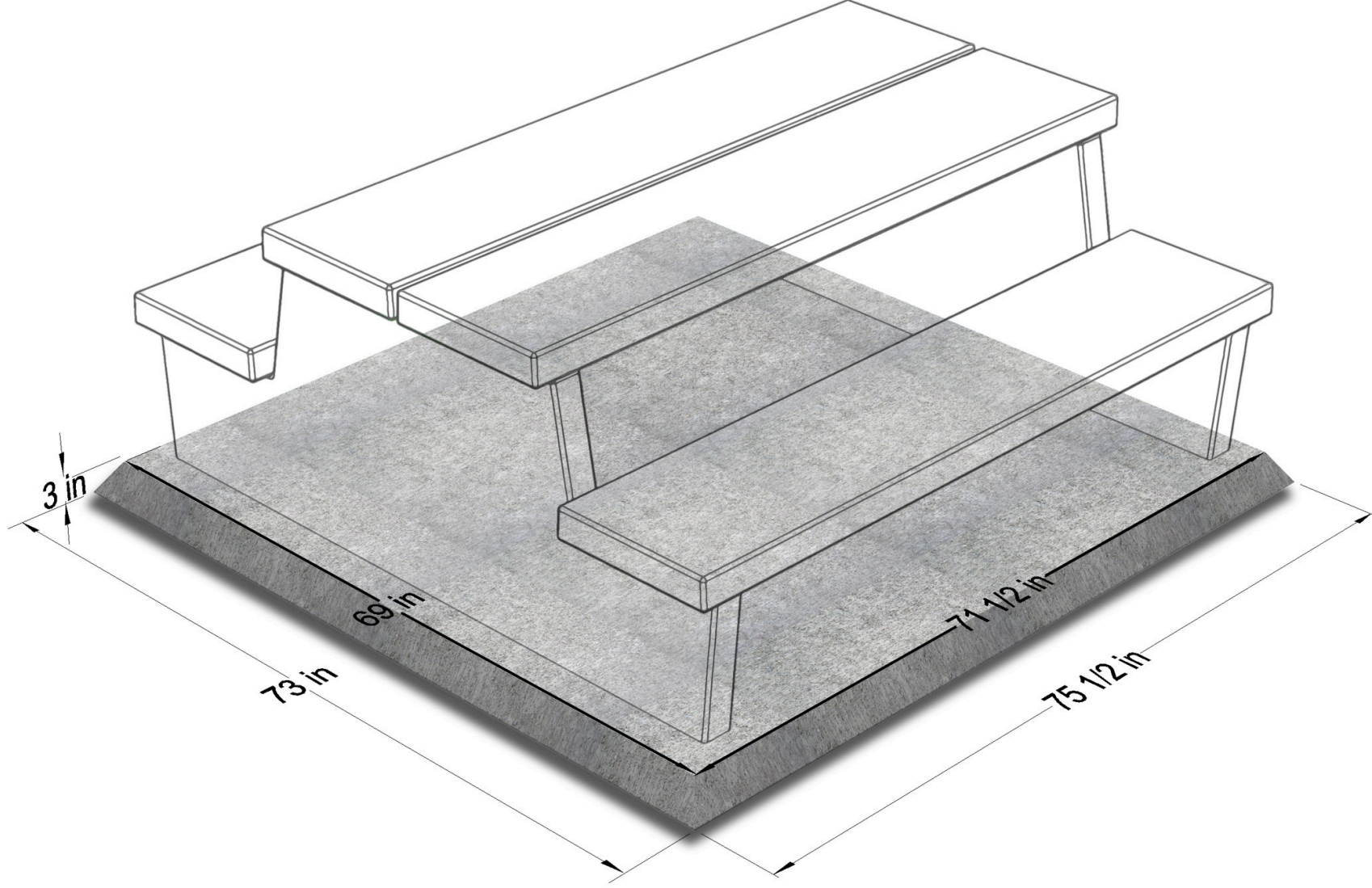

601 Patterson West
Cranbrook, B.C.
PO BOX 491 V1C 4J6
Phone 250-426-8162
Fax 250-489-4013
email: info@trikonprecast.com
www.trikonprecast.com

PICNIC TABLE NO. 1 BASE

DRAWN: RAB

FEB 09/2009

NOT TO SCALE

Table available with a terrazzo finish or with a plain concrete finish

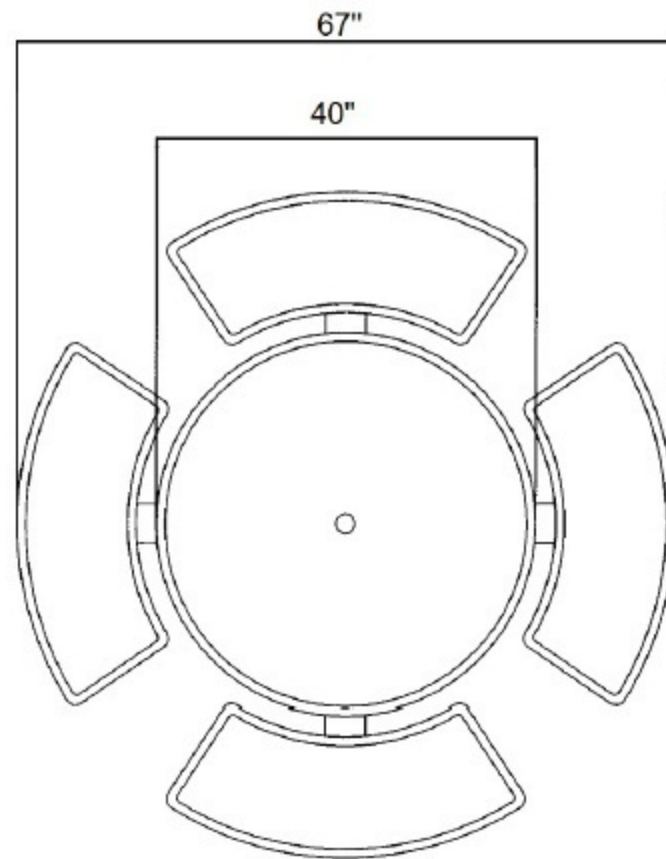

Notes:

Table Top: 40" x 2 1/4" thick
Curved Seats: 40" x 10 1/4" x 2" thick

Weight: 1100 lbs.
Material: Reinforced Concrete
Reinforcing: 1/4" Steel Rebar

Terrazzo Finish



Plain Concrete

Note:

Plain Concrete finish comes with exposed legs only, not the sides of the seat/top as shown.

Installation Instructions for Round Picnic Table

****Note: Handle ALL concrete parts carefully.****

Step 1	First, determine the area where your table(s) are going to be installed. Each table is 67 inches in diameter.
Step 2	<p>Using a two wheeled moving dolly, move the bottom leg (leg with a rectangle notch on the top) into position. Do not leave legs sitting upright unattended in case they should tip over causing damage or injury!</p> <p>Position a top leg (leg with a rectangle notch on the bottom) at the end of the bottom leg. Now install 2 seat brackets on each end of the leg using the 7" x $\frac{3}{8}$" bolts, nuts and 4 fender washers per bolt. Just finger tight for now. Carefully lift the top leg over the bottom leg and into the notch on the bottom leg.</p> <p>(When lowering do not allow it to jam and don't force it down.)</p>
Step 3	Install the large table top plate. (Keep rotating until the 2 holes line up with the holes in the legs. Insert 2 of the 7" bolts thru the holes in the legs. Use one of the fender washers on the steel bracket side and 2 or 3 on the concrete side. Now using a broom handle, line up the umbrella holes in the legs, then tighten the 7" bolts until the washers bend slightly.
Step 4	<p>Now place the table top on the steel plate, slowly and carefully rotate the top until you line up one of the 4 inserts in the bottom of the table top with one of the holes in the steel plate. Then install one 1" x $\frac{1}{4}$" x $\frac{3}{8}$" bolts with one fender washer.</p> <p>Adjust the table top until the other 3 holes line up and insert and install remaining 1" x $\frac{1}{4}$" x $\frac{3}{8}$" bolts and fender washers. (Do NOT over tighten the bolts. $\frac{1}{4}$ turn past snug.)</p>
Step 5	Install the seats one at a time using 4 of the 1 $\frac{1}{4}$ " x $\frac{3}{8}$ " bolts per seat. Each of the 4 bolts should have a rubber washer sandwiched between 2 fender washers. Tighten these bolts carefully, until the rubber washer is slightly compressed.
Step 6	Be sure all the legs are touching the ground and not hung up or on uneven ground. If the site is uneven use shims to make the legs level.
Step 7	Level the seats and tighten the 7" bolts very tight, until the washers bend slightly.